

**Production Features**

Spacious 3 Tier Production Area with seating for eleven
62 - Video monitors at Front Production Desk
8 - 8" Video monitors at the Second Production Desk
8 - 8" Video monitors at the Third Production Desk

Video

Grass Valley Kalypso Digital Switcher
80 input, 4 ME, Internal DVE (Transform) and Still Store,
4 keyers per ME, 32 Outputs
Programmable Clean Out, Timeline control
Accom Dual Twin DVEous
Codi Telestrator

Camera (16:9 switchable)

Wired for 12 Cameras
6 - Ikegami HK-388W Digital Cameras
4 - Ikegami HK-388PW Digital Cameras
6 - Fujinon 70 X Lenses
4 - Fujinon 20 X handheld Lenses
3 - LPS/Clock Cameras
6 - Vinton Vector 70 heads with Mathews sticks
4 - Vinten Pan Heads and Tripods
2 - Wide angle Lenses

VTR

Wired for 10 VTR's and (2) 4-Channel EVS
1 - 4 Channel EVS LSM XT with X-File
1 - 2 Channel Omega Fast Forward DDR with Lance
4 - Sony DVW 500 Digibeta
2 - Sony BVW 75 Beta SP
2 - DVD Player / Recorder
5 - DNF Slo-Mo Controllers
54 - Video monitors in VTR/EVS Area

Audio

Yamaha PM-4000 audio Mixer with 56 mono inputs
4 Stereo Inputs, 10 VCA, 8 Groups, 12 Aux, 10 Matrix
2 - 360 Systems Digicart II's
1 - CD Player
3 - DBX - 160A series compressors/limiters
3 - DBX - 166X series compressors/limiters
1 - Broadcast Sports Processor Stereo Simulator
6 - Sennheiser Commentator Headsets
6 - Daltech Announce Boxes
4 - Sennheiser ME 66 Shotguns
25 - Shotguns (3 - 416, 3 - ME 66, 1 - MKH 70
6 - AT 835B, 2 - AT 815A, 4 - AT 815B)
2 - Sennheiser MD 46 Hand Mic
10 - EV Hand Mic (3- RE 50B, 7- 635A)
10 - Sony Lav mic (5- ECM-44, 5- ECM-77)
1 - Tektronix 760 Phase Meter
10 - Video monitors in Audio

Routing

Pesa Jaguar 64 X 64 SDI Video Router
Pesa Cougar 32 X 32 Analog Video
Pesa Jaguar 64 X 64 Audio Router
18 - 40 button controllers with breakaway

Graphics

Wired for 2 Graphics Units
Chyron SDI Duet LEX with clip player

Terminal

18 - Leitch Digibus Frame Syncs
52 - GVG Video Digital/Analog Converters
GVG Sync Generators and Video Proc
2 - For A Color Correctors
2 - Panasonic Quad Splitters

Communications

RTS/Telex ADAM with 80 Ports
16 - KP 32 panels
8 - KP 12 panels
12 - Powered PL Channels
12 - IFB Channels
20 - BP 325 Intercom Beltpacks
4 - Biscuit Boxes
13 - 4030 or 4020 IFB Beltpacks
1 - SAP 1626 Source Assign Panel
2 - TIF921 Dual Telephone Interface
2 - Telos One + One Dual Telephone Hybrids
4 - Comrex Phone Hybrids
30 - Beyer Headsets (15 Single, 15 Double)
16 - RTS/Telex lightweight Headsets
6 - Motorola UHF Radios
2 - Motorola UHF Base Stations
4 - Stereo Headphones
9 - Powered Speakers
10 Line Merlin telephone system with ring downs

External Monitors

4 - 13" Color
6 - 8" Color

Power

208V, 200 amps 3 phase
150' Camlock
2 - 6 ton AC with heaters

Overall Dimensions

53' AMP Expando Trailer
57' overall Trailer Length
Expandable section 36' x 48"
13' 6" high, 8' 6" wide (12' 6" expanded)
80,000 lbs (36,400 kgs) with Tractor



M-10

Layout

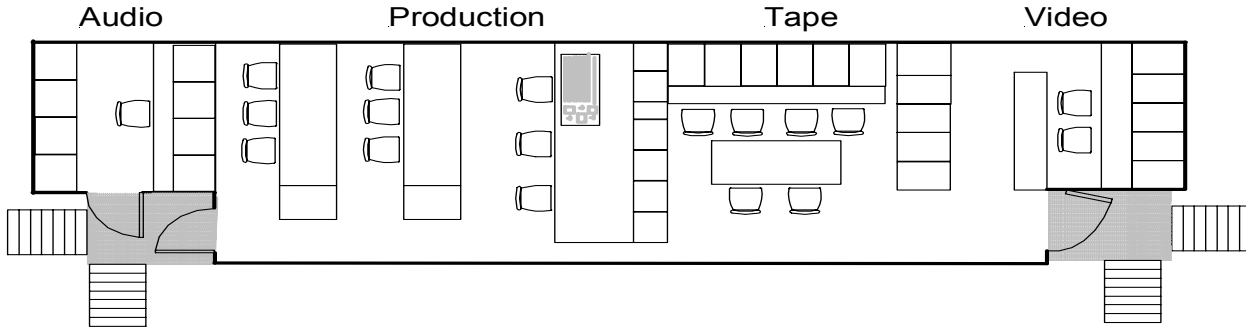

Monitor Wall

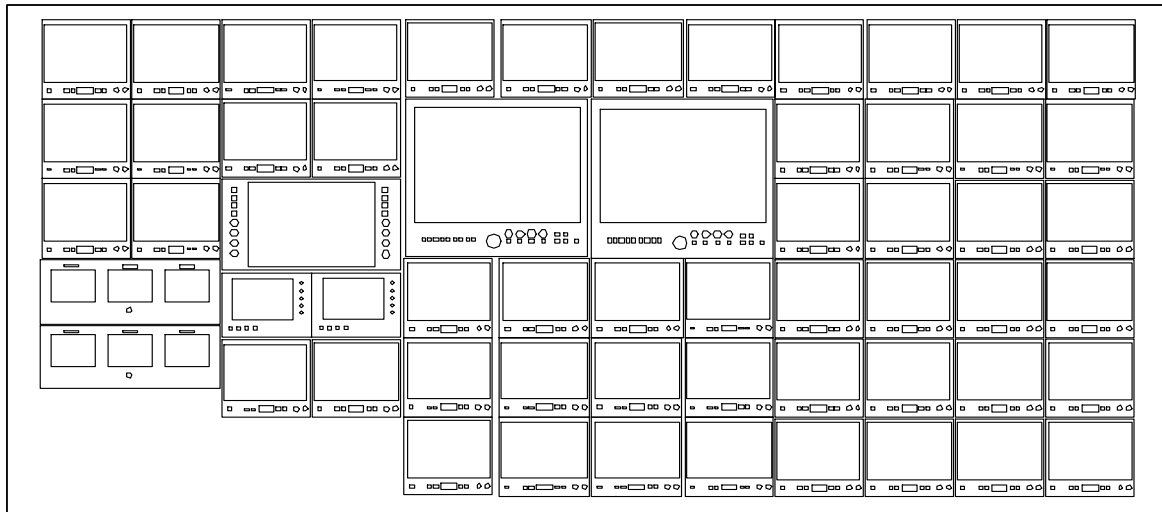

Director of Business Development

Frank Coll

cell 310-629-0160

fax 310-534-3047

fcoll@miramobile.com

www.miramobile.com

Director of Sales

Steve Meyer

office 503-464-0811

cell 971-563-6387

fax 503-464-0897

smeyer@miramobile.com

www.miramobile.com