



53' HD EXPANDO

503-464-0900

M-4HD

Specs as of 1/1/10

Production Features

Spacious 3 Tier Production Area with seating for eleven
66 - Video monitors at Front Production Desk
8 - 8" Video monitors at the Production Two/Chyron Desk
6 - 8" Video monitors at the Production Three Desk

Video

Grass Valley Kalypso HD Digital Switcher
90 input, 4 ME, Internal DVE and Still Store,
4 keyers per ME, 32 Outputs, Timeline control
Accom Dual Twin DVEous
PointMaker Telestrator

Camera

Wired for 12 Cameras
8 - Sony HDC-1450 HD Triax Cameras
6 - Sony HDLA-1500 Studio Sled with 7" Viewfinders
2 - Canon HD 86 X Lens with stabilization
1 - Canon HD 75 X Lens with stabilization
3 - Canon HD 72 X Lenses
3 - Canon 21 X hand held Lenses
Wide Angle Lenses available on request
2 - LPS/Clock Cameras
6 - Vinton Vector 700/70 heads
4 - Sachtler Video 18 Plus heads

Media Storage

Wired for 10 VTR's and (4) 4-Channel EVS
1 - Panasonic DVC Pro HD 1700 VTR
2 - Sony Digibeta (1- DVW-A500, 1- DVW-500)
1 - Sony BVW 70 Beta SP
2 - 4 Channel HD EVS LSM XT (2) (2 In - 2 Out)
1 - 4 Channel HD EVS RO XT (2) (2 In - 2 Out)
1 - HD Spotbox or 4 Channel HD EVS RO XT (2)
1 - EVS X File Digital Archive Station
1 - 2 Channel Omega Fast Forward DDR with Lance
2 - VHS
2 - DVD Player / Recorder
2 - DNF Slo-Mo Controllers
61 - Video monitors in VTR/EVS Area

Routing

Leitch Integrator 96 X 96 HD Video and Analog Audio
Leitch Integrator 128 X 128 Analog Video
12 - Single buss 64 button controllers with breakaway
2 - 4 buss X/Y controller
Image Video Tally Mapper / GPI Router

Graphics

Wired for 2 Graphics Units
1 - Chyron HD Duet Hyper X (HD only, no C-Mix)

Terminal

4 - DPS 575 Frame Syncs
4 - AJA FS1 Frame Syncs
2 - Leitch X-75 Multi-Converters
Leitch Conversion and Proc amps

Audio

1 - Yamaha PM-5000 Mixer, 66 inputs (38 mono-14 Stereo)
12 VCA, 8 Groups, 12 Aux, 8 Mono and 4 Stereo Matrix
126 - Leitch Audio D/A's (54 Stereo, 18 Mono)
2 - 360 Systems Digicart E's
1 - Sony CD Player
8 - DBX - 166 series stereo compressors/limiter
2 - Telos One + One Dual Telephone Hybrids
2 - Gentner DH 30 Hybrids
4 - Sennheiser Commentator Headsets
4 - Daltech Announce Boxes
10 - Sennheiser Shotguns (5- ME 66, 5- ME 67)
2 - Shure VP88 Stereo Mic
2 - Sennheiser MD 46 Hand Mics
6 - Hand Mic, 4- RE 50B, 2- 635A
4 - Sony ECM 55B Lav mic
5 - Rane Audio Delays
9 - Video monitors in Audio

Communications

RTS/Telex ADAM with 72 Ports
18 - KP 32 panels
4 - KP 12 panels
12 - Powered PL Channels
12 - IFB Channels
12 - BP 325 Intercom Beltpacks
10 - 4030 IFB Beltpacks
1 - SAP 1626 Source Assign Panel
2 - TIF951 Dual Telephone Interface
22 - Beyer Headsets (11 Single, 11 Double)
20 - RTS/Telex lightweight Headsets
4 - Motorola 16 Channel UHF Radios
2 - Motorola 20 Channel UHF Base Stations
20 Line telephone system

External Monitors

2 - 14" Color
2 - 15" LCD's
2 - Sharp 13" (4:3) LCD
6 - 8" Color

Power

208V, 200 amps 3 phase
150' Camlock
2 - 6 ton AC with heaters
1 - 3 ton AC for room environmental

Overall Dimensions

53' Gerling Expando Trailer
57' overall Trailer Length
Expandable section 33' x 60"
13' 6" high, 8' 6" wide (13' 6" expanded)
80,000 lbs (36,400 kgs) with Tractor



53' HD EXPANDO

503-464-0900

M-4HD

Layout

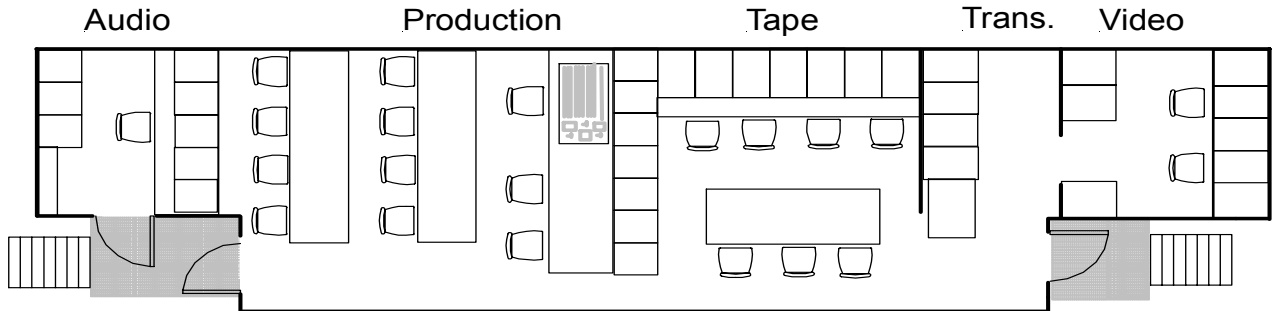

Monitor Wall

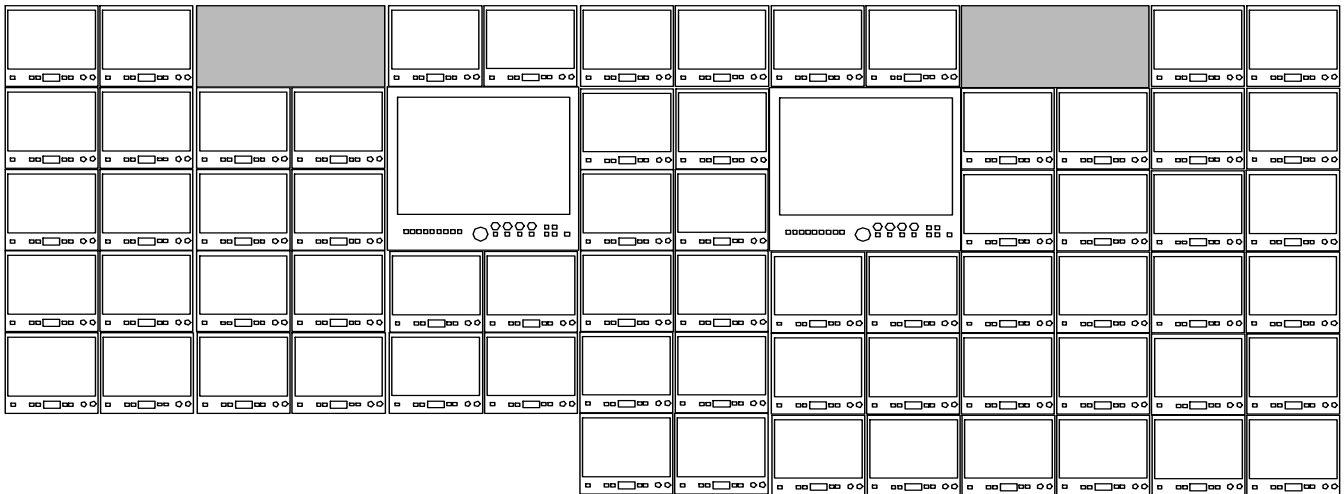

Director of Business Development

Frank Coll

cell 310-629-0160

fax 310-534-3047

fcoll@miramobile.com

www.miramobile.com

Director of Sales

Steve Meyer

office 503-464-0811

cell 971-563-6387

fax 503-464-0897

smeyer@miramobile.com

www.miramobile.com