



53' HD EXPANDO

503-464-0900

M-7HD

Specs as of 1/1/10

Production Features

Spacious 3 Tier Production Area with total seating for twelve including four at the front console
118 - Video monitors at the Front Production Desk using 28- Evertz VIP multi-display units
10 - Video monitors at the Second Production Desk
8 - Video monitors at the Third Production Desk

Video

Grass Valley Kalypso HD Digital Switcher
90 inputs, 4 ME, Internal DVE and Still Store,
4 keyers per ME, 48 Outputs, 6 Transform Engines
DVEous HD DVE
PointMaker Telestrator
24p Capable

Camera

Wired for 16 Cameras
10 - Sony HDC-1550 HD Cameras
7 - Sony Large Lens Studio Sleds with 7" Viewfinder
1 - Fujinon 101 X 8.9 Lens with stabilization
6 - Fujinon 88 X 8.8 Lens with stabilization
3 - Fujinon 22 X 7.8 Lens
2 - Fujinon 13 X 4.5 Wide Angle Lens
7 - Cartoni Omega heads
5 - Cartoni Gamma heads
2 - LPS/Clock Cameras

Media Storage

1- 6 Channel HD EVS LSM XT (2)
1- 4 Channel HD EVS LSM XT (2)
2 - 4 Channel HD EVS RO XT (2)
1 - HD Spotbox or 4 Channel HD EVS RO XT (2)
1- Lance Controller
1- EVS X File Digital Archive Station
Wired for 10 VTR's
1 - HDW 1800 HDCam VTR
1 - Sony PDW HD1500 XDCam
1 - Sony BVW 75 Beta SP
1 - Sony DVW M2000 Digibeta
2 - DNF Slo-Mo Controllers
48 - Monitors in VTR Area using 6- Evertz VIP
24 - Monitors in VTR Area using 3- Evertz VIP

Graphics

1 - Chyron HyperX 2

Routing

Pesa 288 x 576 HD Video Router
Pesa 128 x 128 AES Router
Pesa 128 x 128 Analog Stereo Router
7 - 32 button controllers with breakaway
18 - 64 button controllers with breakaway
6 - 128 button controllers with breakaway
1 - Desktop Controller (Lighting Director)

Terminal

10 - HD Frame Syncs with color correction
3 - Leitch X-75 HD Frame Syncs
20 - HD Up-Down-Cross converter
30 - HD Down converter

Audio

Calrec Sigma Audio Desk with Bluefin
96 Mono Analog Mic or Line Inputs
96 Mono Analog Line Outputs
64 AES Inputs, 64 AES Outputs
104 Mono Channels
104 Stereo Channels
SRS and Dolby Processing
Full 5.1 Monitoring
DBX Outboard Compressors-Limiters
Rane Outboard Delays
2 - 360 Systems Digicart E's
1 - CD Player
Full Microphone Compliment

Communications

RTS/Telex ADAM 96 x 96
14 - KP 32 panels
14 - KP 12 panels
12 - Powered PL Channels
16 - IFB Channels
30 - BP 325 Intercom Beltpacks
10 - 4030 IFB Beltpacks
1 - SAP 1626 Source Assign Panel
4 - 2000A Telephone Interface
40 - Beyer Headsets (20 Single, 20 Double)
20 - RTS/Telex lightweight Headsets
4 - Biscuit Boxes
6 - Motorola UHF Radios
2 - Motorola UHF Base Stations
12 Line Avaya Partner telephone system

External Field Monitors

6- 9" HD LCD
4- 9" Color
4- 15" SD LCD's
4- 13" Color

Power

2 - 208V, 200 amps 3 phase
150' Camlock
2 - 10 ton AC with heaters

Overall Dimensions

53' Gerling Expando Trailer, Expandable section 51' x 60"
57' overall Trailer Length



53' HD EXPANDO

503-464-0900

M-7HD

Layout

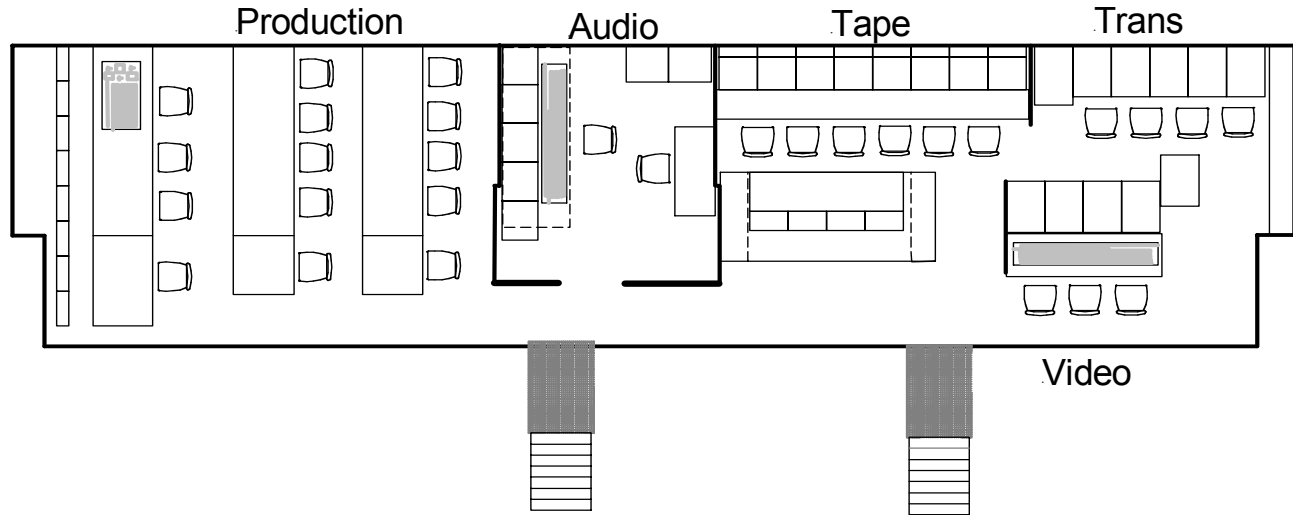

Monitor Wall

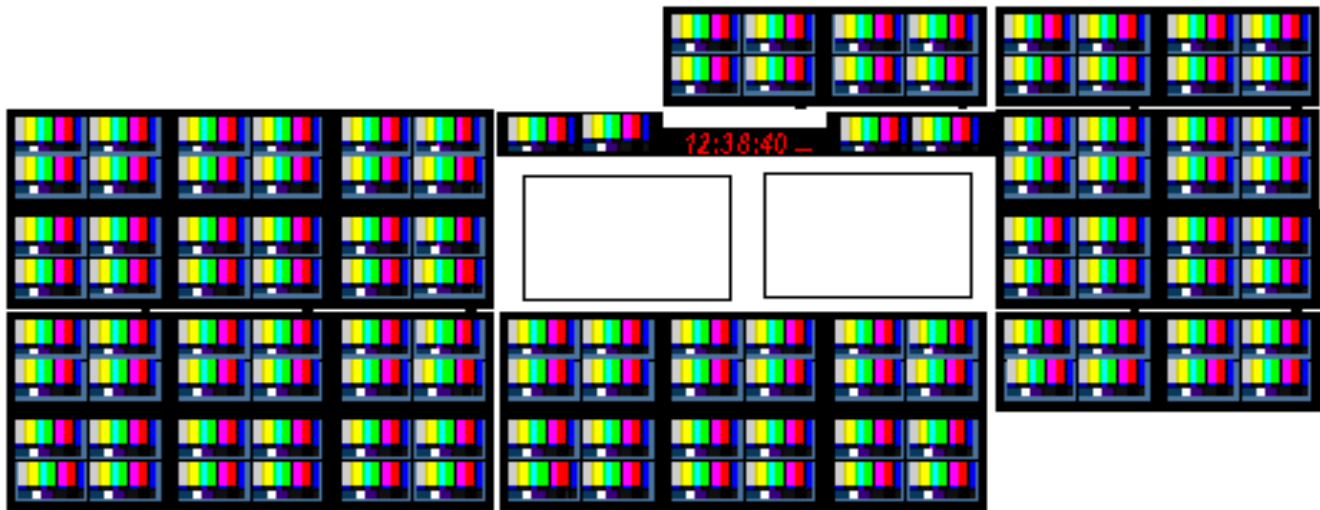

Director of Business Development

Frank Coll

cell 310-629-0160

fax 310-534-3047

fcoll@miramobile.com

www.miramobile.com

Director of Sales

Steve Meyer

office 503-464-0811

cell 971-563-6387

fax 503-464-0897

smeyer@miramobile.com

www.miramobile.com